



Diaphragm-Type Diaphragm Seal

Threaded Plastic Diaphragm Seal

Type L990.PA

Diaphragm Seals

Application

Protect pressure instrument from corrosive, contaminated or viscous media.

Design

Internal clamped diaphragm with threaded process connection; requires hydraulic fluid to transmit pressure to instrument

Process Connection

¼" to ½" NPT-female

Instrument Connection

¼" NPT-female

Suitable Pressure Ranges (MWP 160 PSI @ 100°F)

15 PSI to 160 PSI (no vacuum or compound ranges)

Available Options (connections, materials, etc.)

See Selection Guide (over)

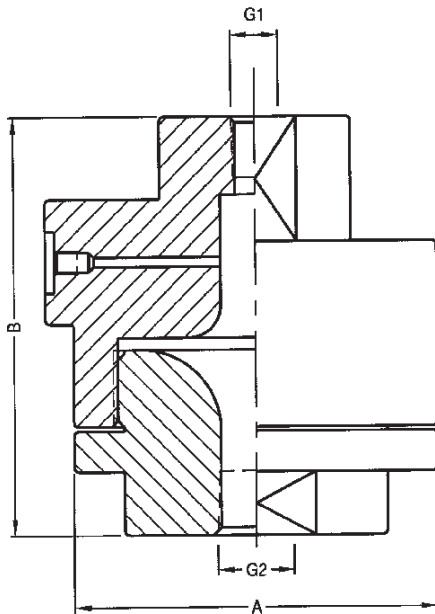

DM: EFFECTIVE DIAPHRAGM DIAMETER

G1: INSTRUMENT CONNECTION

G2: PROCESS CONNECTION

ALL DIMENSIONS IN INCHES UNLESS OTHERWISE NOTED

G1	G2	A	B	DM	WEIGHT (lbs)		
					PVC	PP	PVDF
1/4"NPT	1/4"NPT OR 1/2"NPT	2.05	2.3	1.2	0.25	0.22	0.28

DWG.#2212374-5

To determine the effects of temperature and response time in a specific application, contact the factory for an **Application Questionnaire**. The information provided will allow WIKA Technical Support to accurately model your application parameters using state-of-the-art computer simulation techniques.

ACSL990.PA
(ACS 99.11T)

Selection Guide - L990.PA

L990.PA, 1/4FX1/4F, CPVC, CPVC, NA, VI

Diaphragm Material
VI = Viton®

Bolting
NA = Not applicable

Lower Housing Material
CPVC = CPVC
PVDF = Polyvinylidene Flouride (Kynar®)
PP = Polypropylene

Upper Housing Material
CPVC = CPVC
PVDF = Polyvinylidene Flouride (Kynar®)
PP = Polypropylene

Process Connection
1/4F = 1/4" NPT female
1/2F = 1/2" NPT female

Instrument Connection
1/4F = 1/4" NPT female
1/2F = 1/2" NPT female
G1/4 = G1/4 female
G1/2 = G1/2 female

Diaphragm Seal Design, MWP = 160 PSI (See note 1)
L990. PA = Plastic body, d_m = 1.2" (See note 2)

Notes

1. See chart below for stocked items. Some non-stock configurations may require minimum order quantities. (Consult factory)
2. For use with 1-1/2", 2", and 2-1/2" gauges only.

*Items in **bold** are available from stock (subject to prior sales). For optional items, consult factory for current lead-time.*

Options not listed may be available, please consult factory.
Fill fluids and mouting options: Please reference datasheet ACS 99.MO

THE MEASURE OF
Total Performance™

Ordering Information:

State computer part number (if available) / type number / size / range / connection size and location / options required.

Specifications given in this price list represent the state of engineering at the time of printing. Modifications may take place and the specified materials may change without prior notice

05/01



WIKAI Instrument Corporation

1000 Wiegand Boulevard

Lawrenceville, Georgia 30043-5868

Tel: 770-513-8200 Fax: 770-338-5118

<http://www.wika.com> e-mail: chemseal@wika.com