



Diaphragm-Type Diaphragm Seal

Pancake-Type Flanged Flush Diaphragm

Type L990.28

Diaphragm Seals

Application

Process industry diaphragm seal to combine with pressure transmitters and Bourdon tube pressure gauges. Intended for corrosive, contaminated, hot or viscous pressure media.

Design

Wafer "pancake" flange with integral diaphragm which requires hydraulic fluid to transmit pressure to instrument.

Process Connection

2" to 5" per ASME/ANSI B16.5

Instrument Connection

Capillary or 1/4" NPT-female

Suitable Pressure Ranges

10 inH₂O to class 2500, depending on flange and diaphragm size and process conditions

Available Options (connections, materials etc.)

See Selection Guide (over)

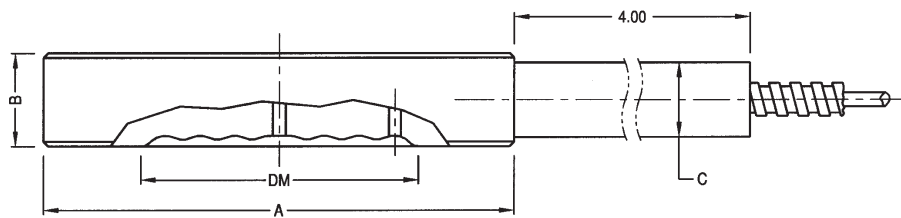

DM=EFFECTIVE DIAPHRAGM DIAMETER
CLASS=FLANGE RATING PER ASME B16.5
ALL DIMENSIONS IN INCHES UNLESS OTHERWISE NOTED

SIZE	CLASS	A	B	C	DM
2"	150#-2500#	4.00	0.78	0.63	2.4
3"		5.28			3.5
4"	150#-1500#	6.22			3.5
5"		7.33			4.9

DWG.#2212153-5

To determine the effects of temperature and response time in a specific application, contact the factory for an **Application Questionnaire**. The information provided will allow WIKA Technical Support to accurately model your application parameters using state-of-the-art computer simulation techniques.

ACS L990.28
(ACS 99.05)

Selection Guide - Type L990.28

Type L990.28,CPLX2.0-RF,SS,SS,NO,NONE

Back-up Flange Pressure Rating

NONE = Without back-up flange

150R = 150#RF

300R = 300#RF

600R = 600#RF

900R = 900#RF

15XR = 1500#RF

25XR = 2500#RF

XXXX = Other (Define flange rating on purchase order)

Back-up Flange Material

NO = Without back-up flange

SS = 316 stainless steel

CS = Carbon-steel passivated, powder coated

Wetted Material

SS = 316 stainless steel

MO = Monel® 400 (See note 2)

HB = Hastelloy® B-2 (See note 2)

HC = Hastelloy® C-276 (See note 2)

TF = 316 stainless steel, virgin Teflon® lined

PF = 316 stainless steel, Teflon® coated

EC = 316 stainless steel, ECTFE (Halar®) coated

IN = Inconel® 600 (See note 2)

IC = Incoloy® 825 (See note 2)

TA = Tantalum (See note 2)

TI = Titanium, grade 2 (See note 3)

NI = Nickel 200 (See note 2)

ZI = Zirconium (See note 3)

SA = 316 stainless steel, gold-plated

Upper Housing Material

SS=316 stainless steel

TI=Titanium, grade 2

Flange Rating (Other facings available)

RF = Raised face

XX = Other (Define flange facing on purchase order)

Process Connection

1.5 = 1.5" Pipe

2.0 = 2" Pipe

3.0 = 3" Pipe

4.0 = 4" Pipe

5.0 = 5" Pipe

Instrument Connection

1/4F = 1/4" NPT female

CPL = Capillary connection (To weld capillary directly to seal)

Diaphragm Seal Design (See note 1)

Type L990.28 = Pancake Type, Flush Diaphragm

Notes

1. Pressure rating based on blind flange rating. Suitable pressure ranges from 10" H₂O, depending on diaphragm size and process conditions.
2. Supplied with a smooth raised face finish.
3. When used with a stainless steel upper housing, diaphragm is bonded to upper housing (max. 300°F media temperature).

Options not listed may be available, please consult factory!
Fill Fluid & Mounting options: Please reference data sheet ACS 99.MO.

THE MEASURE OF
Total Performance™

Ordering Information:

State computer part number (if available) / type number / size / range / connection size and location / options required.

Specifications given in this price list represent the state of engineering at the time of printing.
Modifications may take place and the specified materials may change without prior notice

05/01



WIKAL Instrument Corporation

1000 Wiegand Boulevard

Lawrenceville, Georgia 30043-5868

Tel: 770-513-8200 Fax: 770-338-5118

http://www.wika.com e-mail: chemseal@wika.com